

ABBA

APP Wi-Fi Control landscape transformer

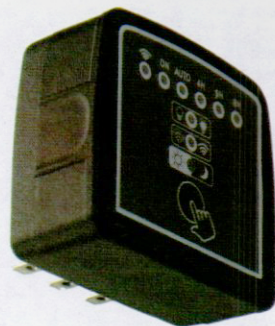

Quick Install Guide

Introduction of the transformer: this transformer can be set both through an APP on your smart phone or manual set on the transformer itself. For manual set, there is ON/OFF/AUTO(photo sensor)/2/4/6/8hrs count down timer modes; ON; light will be always ON

AUTO: light will be ON/OFF by photosensor on the transformer(dusk to dawn working mode)

4/6/8H, light will be ON at dusk and OFF after 4/6/8hrs.

OFF mode (no LED light on the transformer displayed)
Light will be always OFF



For Wifi mode, select to the Wifi icon ON; then press down the selecting button  for 3 sec, when the wifi icon starts blinking, it is ready for wifi connecting (there is two blinking fast and slow way, both are ok to get ready for connecting; press again for slow blinking)



Selecting to Wi-Fi mode



Press down 3 seconds for Wi-Fi connecting

1, Down load the APP to your smart phone

(If your smart phone is already with "Tuya/Smart Life" APP, pls skip to)

1.1 Search for "Smart Life" in Apple's App Store and other major app stores or scan the following QR code to download the Smart Life app.



1.2 After download the "Smart Life" App onto your phone, follow the App to register a user account/Use the App steps

2 Add a Device

2.1 Open the “Smart life” /Tuya APP on your phone, meanwhile make sure the wifi icon is blinking quickly (by press and hold the selecting button on the timer for 3 seconds);

(The Wi-Fi working indicator blinking quickly. You can also try the slowly blinking mode by press down the button on the timer to select the Wi fi icon blink slowly.)

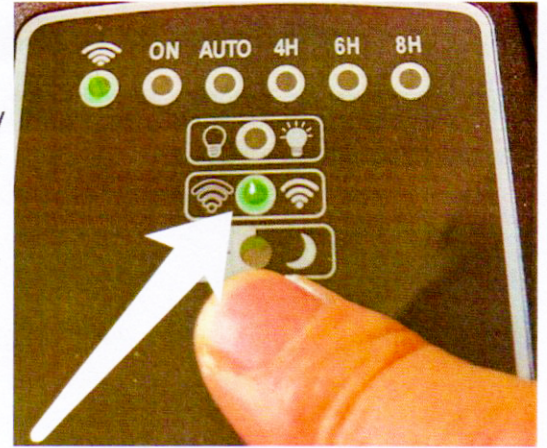

2.2 On the App, start by “add device” /”add manually”/”lighting”/”light source(wifi)” choose Wi-fi 2.4GHz and select your home wifi name /passcode for connecting with the transformer;

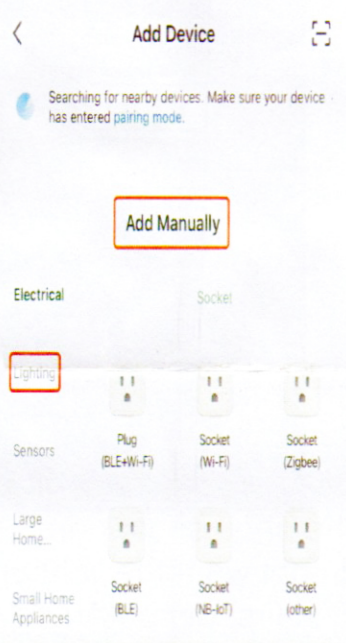
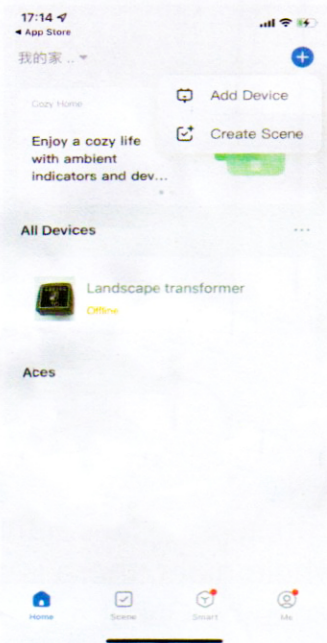

Select 2.4 GHz Wi-Fi Network and enter password.

If your Wi-Fi is 5GHz, please set it to be 2.4GHz. [Common router setting method](#)

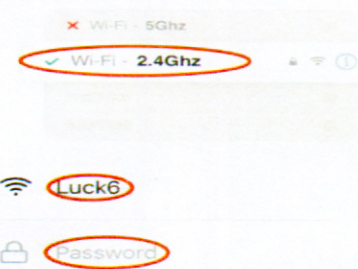

Next



Select the status of the indicator light or hear the beep:

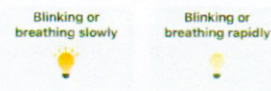

Make sure you choose same blinking mode as on the timer

Make sure the Wi-fi working indicator on the transformer to be blinking mode as what you selected on the APP as below

2.3, After about 30 seconds, the transformer will be connected with your home wifi, you will see it is on your APP list see below; click it for enter the APP operation page for modes setting;

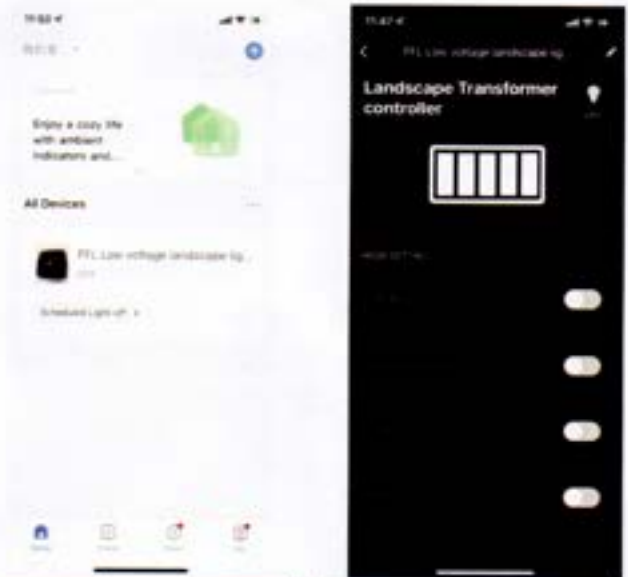

3. USE the APP

(working modes setting)

3.1 ON/OFF & Countdown timer

You can switch ON and OFF the transformer outlet by this mode; Also for ON mode, you can have options for countdown timer option (On till the selected hrs finished).

Notes; Always to "save" for any of your set.

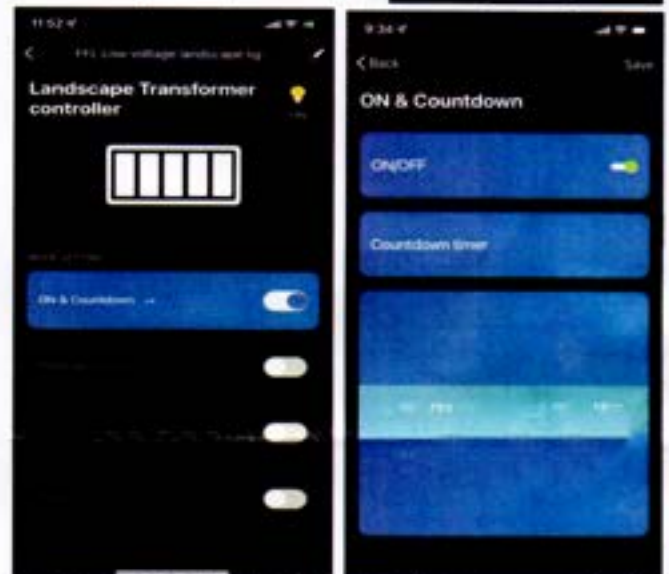

3.2 Photosensor/Auto mode

The transformer will be ON and OFF by the photosensor on the transformer as default mode; Also you can have options if you do not want the light on whole night, there is a way to choose when you want to be OFF in first period/Auto 1 and to be ON at a certain time at early morning in Auto 2 and OFF at dawn time as default mode;

Notes; if you select the OFF time at Dawn time in 1st period(Auto 1), the Auto2 will not effected in operation.

Notes; Always to "save" for any of your set.

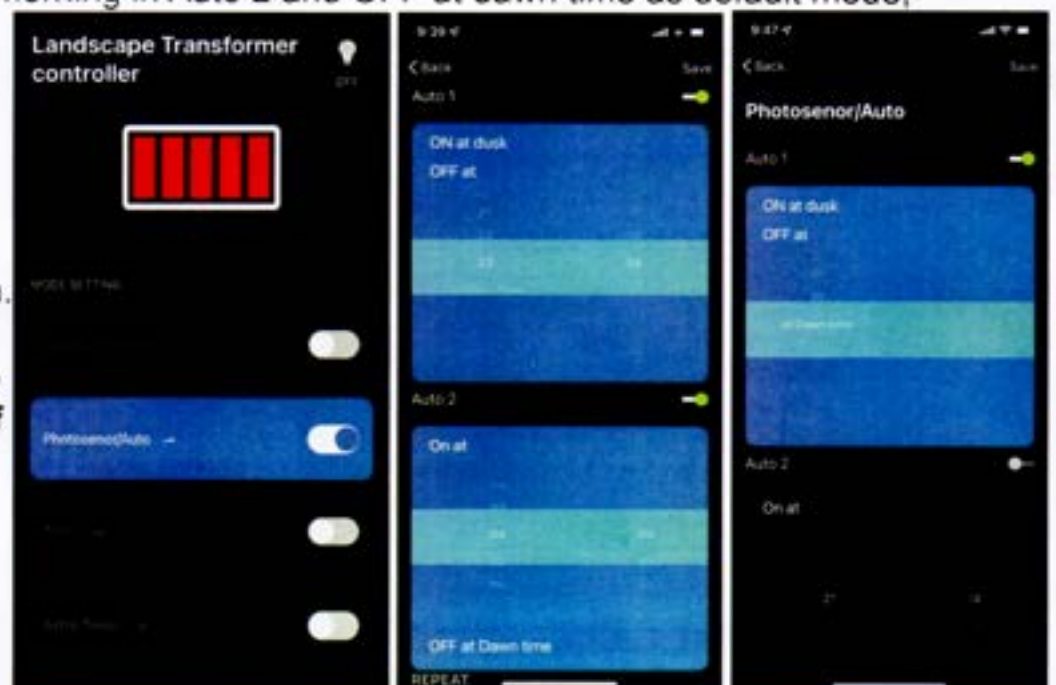

3.3 Timer mode set

You can set the transformer to be ON/OFF at any time and also multi ON/OFF cycles can be set.
Notes; Always to "save" for any of your set.

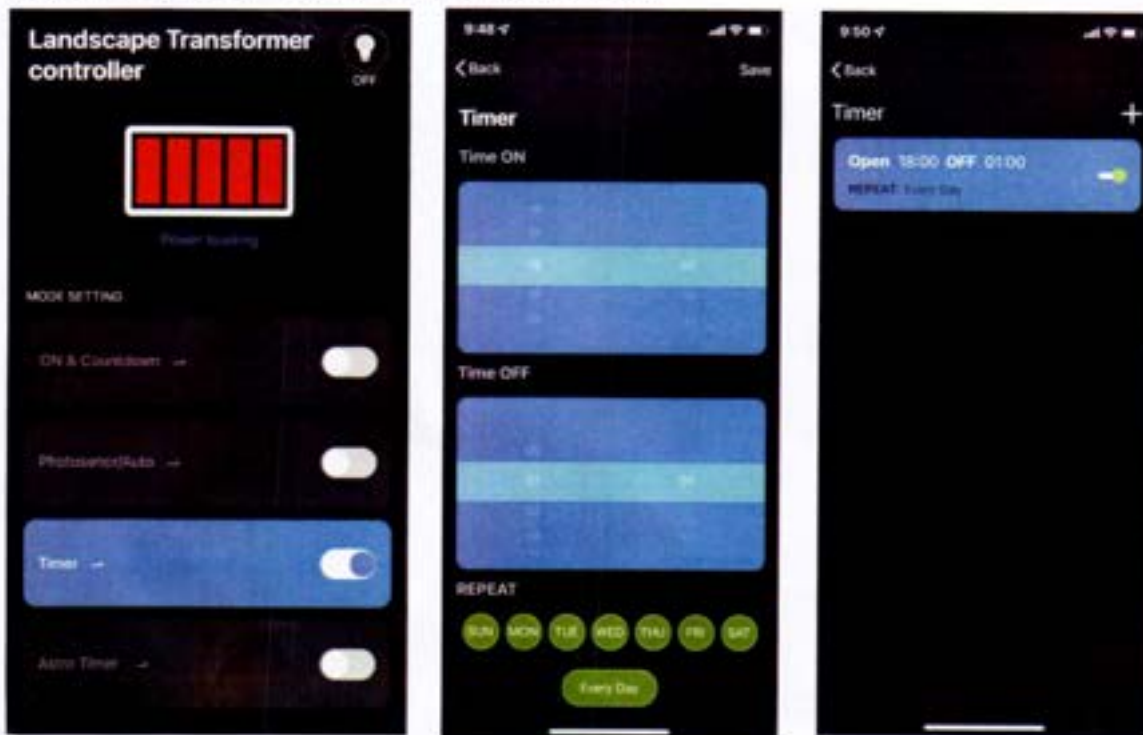

3.4 Astronomic timer mode set (Make sure your city/location on the APP is right)

The transformer will be ON and OFF by your local sunset and rise time as default mode; Also you can have options if you do not want the light on whole night, there is a way to choose when you want to be OFF in first period/Asto1 and to be ON at a certain time at early morning in Astro 2 and OFF at sunrise time as default mode;
Notes; if you select the OFF time at sunrise time in 1st period (Astro1), the Astro2 will not effected in operation.

Notes; Always to "save" for any of your set.



4. Transformer installation;(strongly recommend install indoor or near to your home wifi))

IMPORTANT SAFETY INFORMATION PERTAINING TO RISK OF FIRE OR INJURY TO PERSONS

Do not install within 10 feet(3 m)of a pool, spa or fountain.

For use with 12 volt low voltage outdoor landscape lighting system only Not for use with submersible lights or pool/spa equipment.

There are no serviceable parts inside the power supply unit.

DO NOT DISASSEMBLE

- Do not submerge transformer.
- Do not connect two or more transformers in parallel.
- Do not use with a dimmer.
- Plug the power supply unit directly into a GFCI outlet that is marked "wet location".
- Do not use an extension cord.

The maximum output of this transformer is 150/200/300 watts. Do not overload the transformer.Be sure that the total cumulative wattage of all 12 volt fixtures connected to the transformer is equal to or less than Rated watts.

PLEASE NOTE: This garden light system must be installed in accordance with all local codes and ordinances. If you are experiencing problems, contact a qualified electrician.

Find a location for the transformer

Thames ro the buik in Astronomic timer system, strongly recommend you to install this transformer indoor such as in basement, garage, tool house for prolong the life time of this transformer

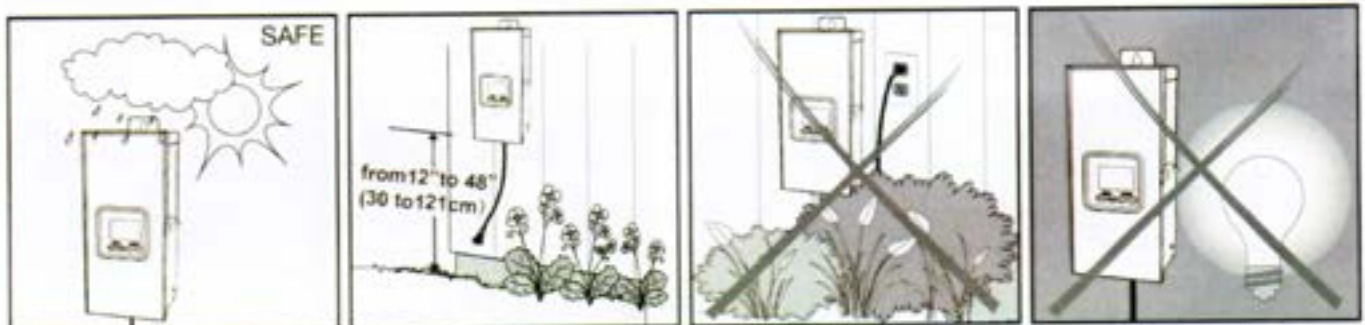

Outdoor use, weather proof. Install the transformer at a level where the controls are visible and accessible.

Only applies in AUTO mode. Do not install behind shrubs. It will affect photocell for Auto dusk-to-dawn mode.

Only applies in AUTO mode. Photocell will not operate prop-erly if installed too close to a nighttime light source.

Connect cable to transformer

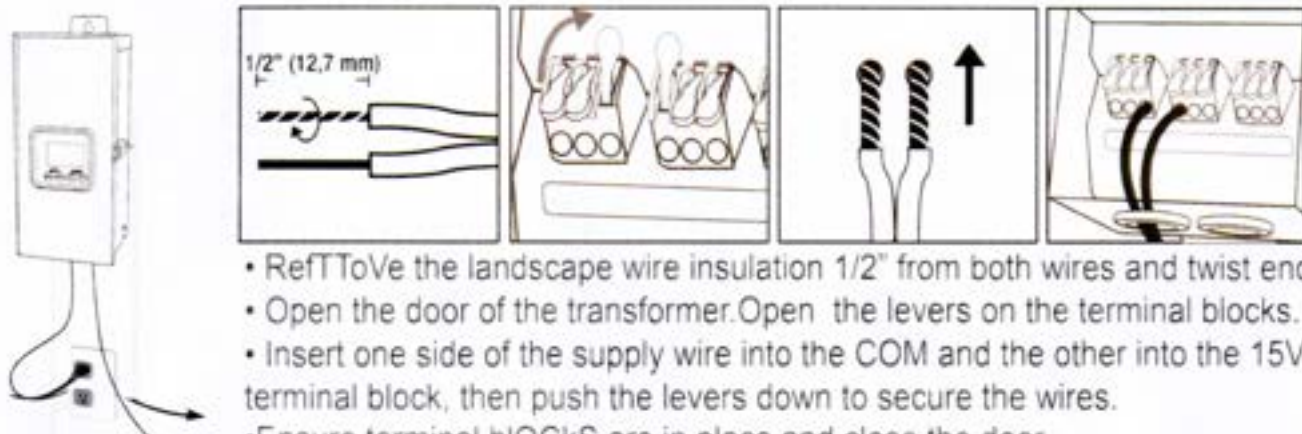

- RefTTToVe the landscape wire insulation 1/2" from both wires and twist ends.
- Open the door of the transformer. Open the levers on the terminal blocks.
- Insert one side of the supply wire into the COM and the other into the 15V terminal block, then push the levers down to secure the wires.
- Ensure terminal bLOCKs are in place and close the door.

Mount the transformer

Insert a screw in a wall near an electrical outlet and mount the transformer.

Note: Use an outdoor, weather resistant screw suitable to the material that you are mounting the transformer onto (mortar screws into cement or brick, wood screws for wood siding). The size of the screw should be at least SAE #4 (Metric M3) to support the weight of the transformer.all near an electrical outlet and mount the transformer.

Run the Landscape Wire (Not Included)

- The landscape wire should run from the transformer to each light without being cut. Do not run the landscape wire within 10 feet (3m) of a pool, spa or fountain. If the landscape wire is too long, cut it with a cable cutter.
- The landscape wire should be protected by routing it close to proximity of the light fixture or next to a building, deck or fence. Use cable suitable for low voltage landscape lighting.

- See chart below for recommended cable gauges

* Suitable cable should be sized in accordance to the table, should be Type SPT-2W.

Combined Wattage of all light fixtures on line(Watts)	Wire Gauge (0-75')	Wire Gauge (75-150')	Wire Gauge (150-250')
0-60	16	16	14
60-120	16	14	12
120-180	14	12	12
180-240	12	12	Not recommended
240-300	12	Not recommended	Not recommended

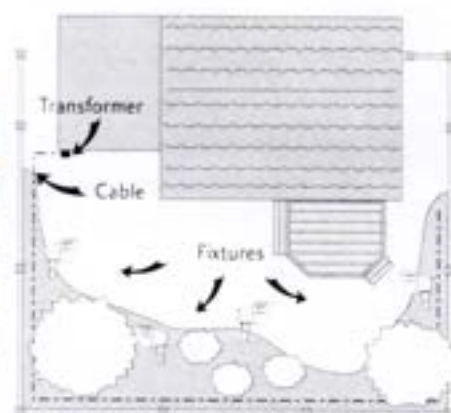

* Illustration of fixtures is for example only

Power up the transformer

Plug the transformer into a GFCI electrical receptacle. To test the fixtures, change the mode to 'ON'.

TROUBLESHOOTING TIPS

If you are having difficulty connecting:

- Make sure the Wi-Fi network is a 2.4 GHz network. Transformer will not connect to a 5 GHz network.
- Test your Wi-Fi network with other devices such as your phone to make sure it is operating properly.
- The Wi-Fi connection may not have good coverage during set up. Try moving the Transformer closer to your Wi-Fi router.
- Your Wi-Fi network password is case sensitive, make sure you are entering correctly.

Please also check the App User Guide for more information

This device complies with Part 15 of the FCC Rules.

Operation is subject to the following two conditions:

- (1) This device may not cause harmful interference, and
- (2) this device must accept any interference received, including interference that may cause undesired operation.

NOTE: This equipment has been tested and found to comply with the limits for a Class B digital device, pursuant to part 15 of the FCC Rules.

These limits are designed to provide reasonable protection against harmful interference in a residential installation. This equipment generates, uses and can radiate radio frequency energy and, if not installed and used in accordance with the instructions, may cause harmful interference to radio communications. However, there is no guarantee that interference will not occur in a particular installation. If this equipment does cause harmful interference to radio or television reception, which can be determined by turning the equipment off and on, the user is encouraged to try to correct the interference by one or more of the following measures:

- Reorient or relocate the receiving antenna.
- Increase the separation between the equipment and receiver.
- Connect the equipment into an outlet on a circuit different from that to which the receiver is connected.
- Consult the dealer or an experienced radio TV technician for help.

LIMITED WARRANTY. This product is warranted to be free from defects in workmanship and materials for up to three years from date of purchase. If the product fails within the warranty period, please contact info@fireflylit.com, visit www.fireflylit.com/contact-us or call XXXXXXXX for instructions on replacement or refund

REPLACEMENT OR REFUND IS YOUR SOLE REMEDY. EXCEPT TO THE EXTENT PROHIBITED BY APPLICABLE LAW, ANY IMPLIED WARRANTIES ARE LIMITED IN DURATION TO THE DURATION OF THIS WARRANTY. LIABILITY FOR INCIDENTAL OR CONSEQUENTIAL DAMAGES IS HEREBY EXPRESSLY EXCLUDED. Some states and provinces do not allow the exclusion of incidental or consequential damages, so the above limitation or exclusion may not apply to you. This warranty gives you specific legal rights, and you may also have other rights which vary from state to state or province to province.

Need Help?

FAQs and the latest versions of user guides can be found at feit.com/help and feit.com/smart.

To reach customer support please email to info@fireflylit.com

VOICE CONTROL;(Pending)

Connect to Google Assistant or Alexa using the in App guide for a temporary open or close if they are not conflict with your current setting on APP.